

- >> Setup/calibration fully menu driven
- >> Easy to calibrate in the field
- >> Replaceable Electrochemical sensing element
- >> Powered by either an AC or DC source
- >> Selectable ranges of 0-100, 150, 300, 400 or 500 ppm



Duct carbon monoxide measurement

The FX-CMS-D carbon monoxide detector uses an electrochemical sensor to monitor the carbon monoxide level and outputs a field-selectable 4-20 mA or voltage signal. The voltage signal may be set to 0-5 or 0-10 Vdc. The sensing range and output may be scaled to either 100, 150, 300, 400 or 500 ppm via the on-board menu. A front panel LCD is standard to ensure easy setup and operation. Other standard features include a back light for the LCD, a front panel test switch, status indication and an alarm buzzer. The test function may also be controlled remotely with a digital input signal. The on-board menu allows local configuration of all device parameters.

Technical features

Sensor Type:	Electrochemical
Sensor Agency Approvals:	UL Recognized for ANSI/UL-2034, UL-2075, E240671
Measurement Range:	0-100, 150, 300, 400, or 500 PPM (Selectable)
Accuracy:	±5 PPM or 5% of reading (whichever is greater)
Accuracy rated:	0° to 50°C (32° to 122°F), 15 to 95% RH
Life Expectancy:	5-7 years in air
Typical Coverage Area:	700 m ² (7500 ft ²) or 15 m (50 ft) radius
Operating Conditions:	-20° to 50°C (-4° to 122°F), 15 to 95% RH, 0.9 to 1.1 atm
Sample Method:	Flow through sample tube
Stability:	<5% signal loss/year
Response Time:	<35 seconds for 90% step change
Power Supply:	24 Vdc ±20% or 24 Vac ±10% (non-isolated half-wave rect.)
Consumption:	100 mA max. with all options on
Protection Circuitry:	Reverse voltage protected and output limited
Output Signal:	4-20 mA (Active), 0-5 or 0-10 Vdc (Selectable)
Output Drive at Capability:	450 ohms max for mA output, 10 Kohms min for V output
Output Resolution:	10 bit PWM (±0.4 ppm)
LCD Display:	Displays PPM and menu parameters 1 PPM resolution, 35 mmW x 15 mm H (1.4" x 0.6") Alpha-numeric, 2 line X 8 character with backlight
Status LED:	2 color (red/green) on front panel
Test Switch:	Performs I/O tests, front panel and remote connection
Buzzer Alarm:	85 db @ 10 feet
Buzzer Trip Point:	Programmable 20-500 ppm in 10 ppm increments
Buzzer Delay:	Programmable 0-10 minutes in 1 minute increments
Wiring Connections:	Screw terminal block (14 to 22 AWG)
External Dimensions:	145 x 101 x 240mm, (5.7" w x 4" h x 9.5" d) includes probe
Enclosure Ratings:	ABS - UL94-V - IP65 (NEMA 4X)
Field Calibration:	By applying calibration gas standards
Manufacturing Process:	ISO9001

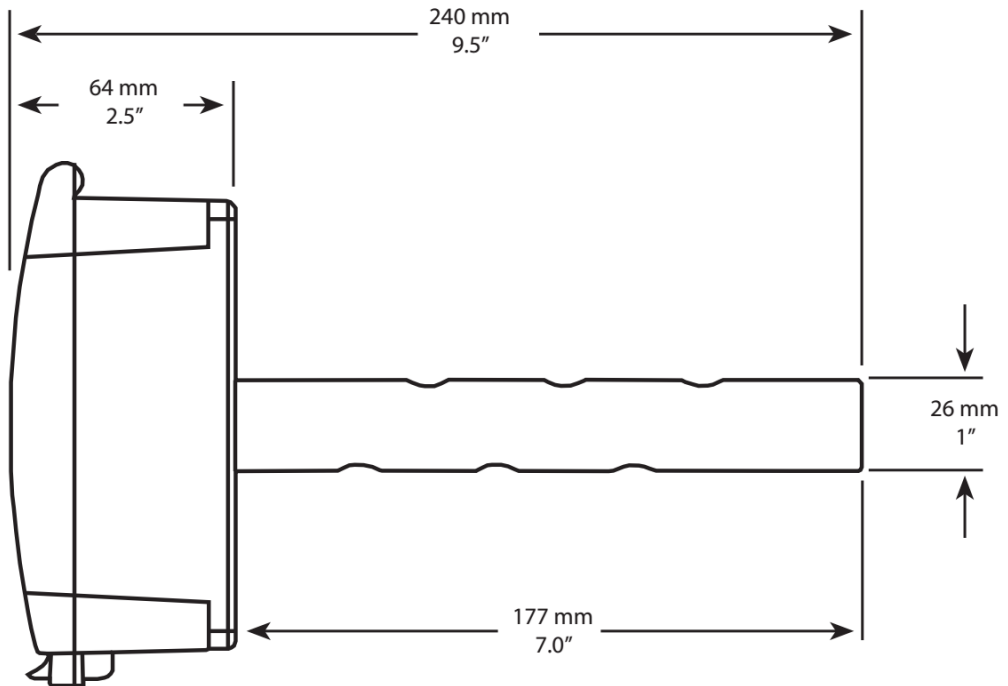
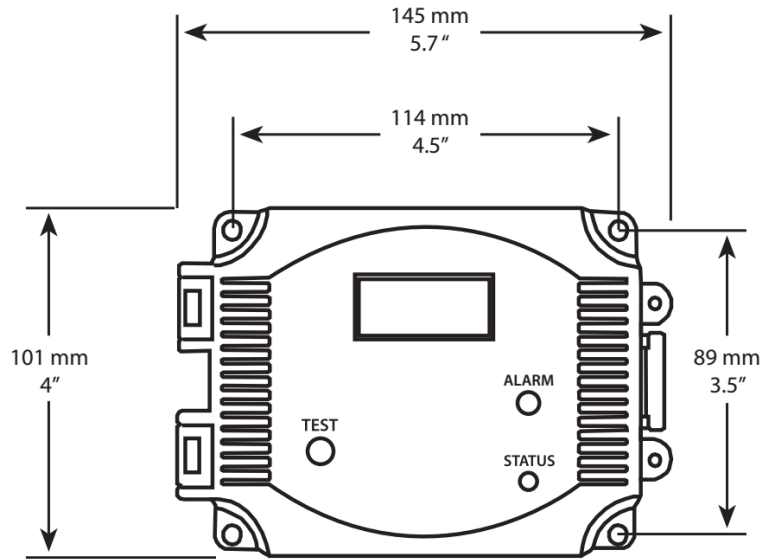
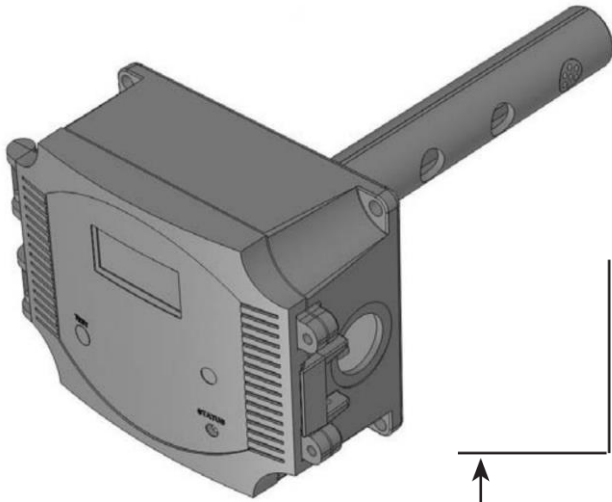

Part number

FX-CMS-D-LCD

0-5/10 Vdc or 4-20 mA, LCD display